

Side Roller Chain

ANSI | Single Pitch | Attachment | SR

“SR” type roller chains are often used on accumulating conveyors. The side rollers may be staggered or parallel, with any spacing configuration. Roller materials are available in carbon steel or low friction plastic.

BS Single Pitch

ANSI Single Pitch

ANSI Double Pitch

ENGL. 81X

Technical Information

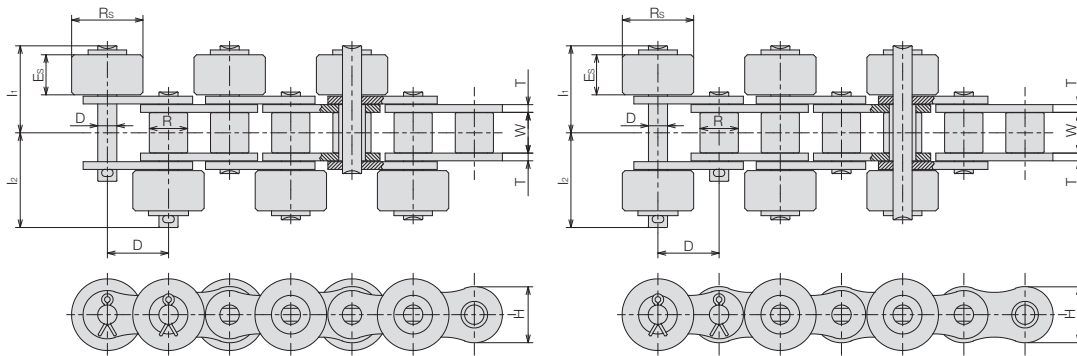

| SY Chain No. | Dimensions - mm | | | | | | | | | | | | | Average Chain Weight kg/m |
|--------------|-----------------|---------|--------|----------------|----------------|-------|----------|-------------|---------|----------------|----------------|------|------|------------------------------|
| | Pitch P | Roller | | Pin | | Plate | | Side Roller | | | | | | |
| | | Width W | Dia. R | Dia. D | Length | | Height H | Thick. T | Dia. Rs | Width Es | Pin-Length | | | |
| | | | | L ₁ | L ₂ | | | | | l ₁ | l ₂ | | | |
| SY 40-1 SR | 12.70 | 7.95 | 7.92 | 3.96 | 8.3 | 9.4 | 11.7 | 1.5 | 15.88 | 7.6 | 17.3 | 19.1 | 0.86 | |
| SY 50-1 SR | 15.875 | 9.53 | 10.16 | 5.08 | 10.2 | 11.8 | 14.6 | 2.0 | 19.05 | 9.2 | 21.4 | 23.1 | 1.40 | |
| SY 60-1 SR | 19.05 | 12.70 | 11.91 | 5.95 | 12.8 | 14.1 | 17.5 | 2.4 | 22.23 | 12.5 | 27.9 | 30.0 | 1.93 | |
| SY 80-1 SR | 25.40 | 15.88 | 15.88 | 7.93 | 16.4 | 19.1 | 23.4 | 3.2 | 28.58 | 15.6 | 34.8 | 37.8 | 3.30 | |
| SY 100-1 SR | 31.75 | 19.05 | 19.05 | 9.53 | 19.7 | 23.3 | 29.3 | 4.0 | 39.67 | 18.5 | 41.9 | 45.5 | 3.57 | |

SR type chain can be manufactured with plastic oversized carrier rollers.