

# Flat Sidebar Roller Chain

BS | Single Pitch | Miscellaneous | F

“F” type roller chains offer high fatigue resistance and are suited for conveyor based products and/or sliding on a surface.

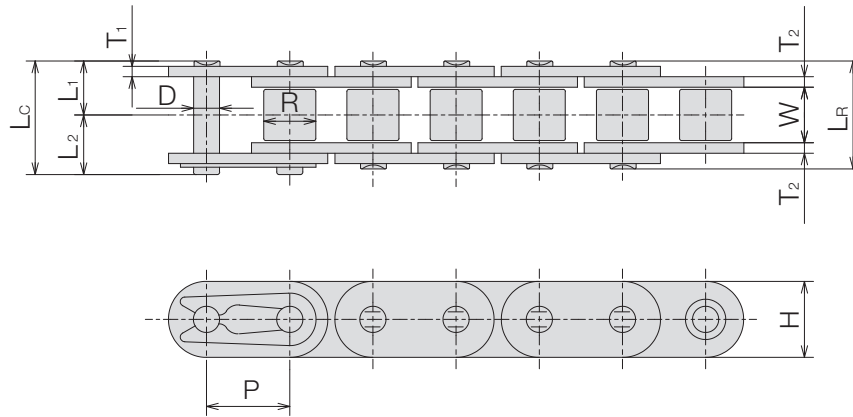

BS Single Pitch

ANSI Single Pitch

ANSI Double Pitch

ENGL. 81X

Technical Information

SY Chain No.	Dimension - mm											Average Tensile Strength kN	Maximum Allowable Load kN	Average Chain Weight kg/m
	Pitch P	Roller		Dia. D	Pin				Plate					
		Width W	Dia. R		Length				Height H	Thickness				
				$L_R$	$L_C$	$L_1$	$L_2$		$T_1$	$T_2$				
SY 08B-1 F	12.70	7.75	8.51	4.45	16.7	18.2	8.4	9.8	11.8	1.5		19.60	3.14	0.68
SY 10B-1 F	15.875	9.65	10.16	5.08	19.4	20.7	9.7	11.0	14.7	1.65		24.60	4.90	0.99
SY 12B-1 F	19.05	11.68	12.07	5.72	22.0	23.6	11.0	12.6	16.1	1.8		32.20	7.06	1.27
SY 16B-1 F	25.40	17.02	15.88	8.26	35.2	38.2	17.6	20.6	20.3	3.2	4.0	66.60	12.60	2.9
SY 20B-1 F	31.75	19.56	19.05	10.16	40.2	44.0	20.1	23.9	26.0	3.5	4.5	105.00	19.60	4.21
SY 24B-1 F	38.10	25.40	25.40	14.63	53.4	58.1	26.7	31.4	32.7	5.0	5.9	177.80	27.50	8.16
SY 28B-1 F	44.45	31.00	27.94	15.88	65.1	70.5	32.6	37.9	36.6	6.3	7.4	222.20	34.30	10.37
SY 32B-1 F	50.80	31.00	29.21	17.81	65.0	71.1	32.5	38.6	41.7	6.3	6.9	275.00	39.20	11.11

Connecting links are “cotter” style for all sizes above 20B F. Offset links are not available.