

# Hollow Pin Chain

ANSI | Single Pitch | Miscellaneous | HP

“HP” type chains are constructed with cold-forged solid bushings. This process assures that the inside diameter of the bushing’s hollow center is completely cylindrical all the way through. This unique hollow pin feature allows for easy insertion of cross rods without damaging the chain or rods.

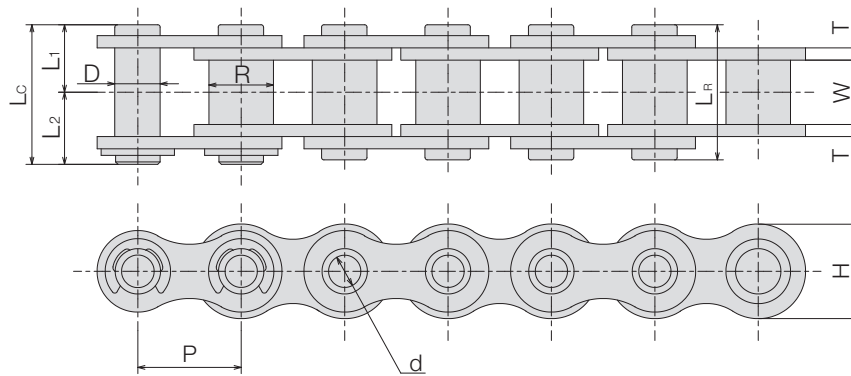

BS Single Pitch

ANSI Single Pitch

ANSI Double Pitch

ENGL. 81X

Technical Information

SY Chain No.	Pitch P	Dimension - mm										Average Tensile Strength κN	Maximum Allowable Load κN	Average Chain Weight kg/m
		Roller		Pin				Plate						
		Width W	Dia. R	Out-Dia. D	In-Dia. d	Length		Height H	Thickness T					
SY 40-1 HP	12.70	7.95	7.92	5.63	4.03	16.7	17.6	8.4	9.2	12.0	1.5	12.70	1.77	0.58
SY 50-1 HP	15.875	9.53	10.16	7.09	5.13	20.1	21.5	10.1	11.4	15.0	2.0	19.60	3.14	0.97
SY 60-1 HP	19.05	12.70	11.91	8.29	6.04	26.0	27.2	13.0	14.2	18.1	2.4	28.40	4.22	1.46
SY 80-1 HP	25.40	15.88	15.88	11.34	8.08	32.4	34.3	16.2	18.1	24.1	3.2	51.00	7.65	2.47

R refers bushing dia.

HP type chains are a bushed chain which made without rollers. Offset links are not available.