

Self Lube Hollow Pin Chain

ANSI | Single Pitch | Lube Free | Miscellaneous | SL HP

“SL HP” type chains are constructed with a one-piece sintered bushing. The sintered bushing has a hollow center that is perfectly cylindrical all the way through allowing for easy insertion of a cross rod. It is ideal for applications that are difficult to lubricate or located in areas that are inaccessible. “SL HP” type chain is lubricated prior to delivery.

BS Single Pitch

ANSI Single Pitch

ANSI Double Pitch

ENGL. 81X

Technical Information

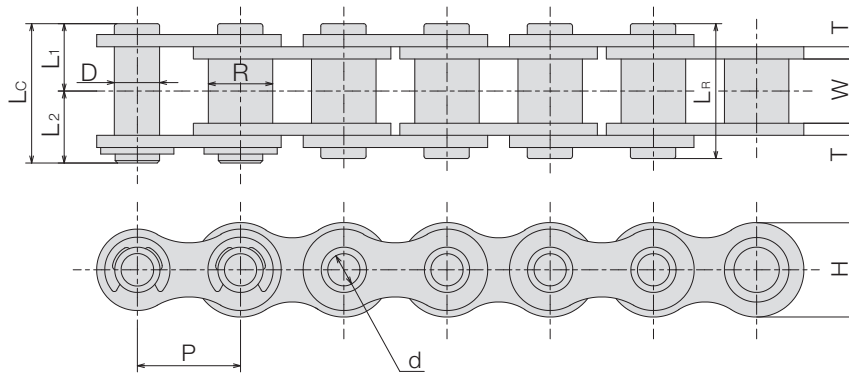

SY Chain No.	Dimension - mm											Average Tensile Strength κN	Average Chain Weight kg/m
	Pitch P	Roller		Pin						Plate			
		Width W	Dia. R	Out Dia. D	Inside d	Length				Height H	Thickness T		
SY 40-1 SL HP	12.70	7.95	7.92	5.63	4.03	16.7	17.6	8.4	9.2	12.0	1.5	12.70	0.6
SY 50-1 SL HP	15.875	9.53	10.16	7.09	5.13	20.1	21.5	10.1	11.4	15.0	2.0	19.60	1.0
SY 60-1 SL HP	19.05	12.70	11.91	8.29	6.04	26.0	27.2	13.0	14.2	18.1	2.4	28.40	1.5
SY 80-1 SL HP	25.40	15.88	15.88	11.34	8.08	32.4	34.3	16.2	18.1	24.1	3.2	51.00	2.5

SL HP type chains are a bushed chain which made without rollers. Consult SUGIYAMA for offset links. Service life decreases dramatically if the lubricant in the oil-impregnated bushings is depleted. The lubrication in the oil-impregnated bushings will seep out rapidly when the operating temperature exceeds 70°C. A wet or dusty environment may lead to premature wearing. It is not recommended for applications which are exposed to chemicals or water, or associated with a shock load.